

LEGEND

HPG	High pressure gauge (Opt)
LPG	Low pressure gauge (Opt)
ATS	Spring type antivibrant mounting (Opt)
ATV	Rubber type antivibrant mounting (Opt)

LIFTING AND CARRIAGE PRECAUTIONS

- Check the weight on the CE label to select appropriate lift equipment .
- Before lifting the unit make sure that the external panel is firmly fixed in place.
- To use only lifting points provided.
- The chains or slings must be of equal length.
- To use a spread-bar to avoid damage to the unit.
- The movement must be performed with caution and avoid abrupt movements.
- Never move the unit on rollers.
- Never lift the unit using a fork-lift.

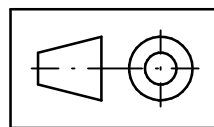

Scala-Scale	Data-Date	Dis.to-Drawn	N°Pezzi	HITEMA®
	30/03/15	M.M.		
Peso-Weight Kg.	Materiali-Materials			DIS.-DRAW N.
Denominazione-Denomination				DIM-CFT-130ST01
WATER CHILLERS mod. CFT.130÷185				Rev.
Particolare-Detail				00
Overall dimension - Lift Instruction				PROGRAM.N.
REFRIGERANT R410a				